

REF. NO.	PART NO.	PART NAME	QTY.
1.	E49-6172	MAIN SPROCKET.....	1
2.	E49-7010	SPROCKET HUB.....	1
3.	E49-1220	MAIN ROTOR THRUST BEARING.....	1
4.	E49-1230	MAIN BEARING.....	1
5.	E00-2602	BOLT (UPPER FLANGE) 3/8 X 1-1/8.....	2
6.	E00-2531	BOLT (LOWER FLANGE) 5/16 X 2-1/4.....	2
7.	E49-1240	LOWER MAIN SHAFT BEARING ASSY.....	1
8.	E00-2450	BOLT 1/4 X 1-1/4 DRILLED HEAD & SHANK.....	4
9.	E36-1712	MAGNET ASSEMBLY ROTOR TACH.....	1
10.	E49-1260	MAIN ROTOR SHAFT SPACER.....	1
11.	E00-2301	BOLT 3/16 X 5/8.....	2
12.	E49-1380	COLLECTIVE SCISSOR MOUNT.....	1
13.	E49-1300	MAIN ROTOR SHAFT SPROCKET HUB ASSY.....	1
14.	E00-9028	HOSE CLAMPS #28.....	2
15.	E00-2608	BOLT 3/8 X 3-1/8.....	3
16.	E00-2525	BOLT 5/16 X 2-1/4 ALL THREAD.....	1
17.	E49-1700	LOWER BEARING BACKING PLATE.....	1
18.	E27-6100	IDLER PULLEY ASSY.....	1
19.	E27-3170	PULLEY MOUNTING ARM WELDMENT.....	1
20.	E27-6150	CLUTCH SPRING TUBE WELDMENT.....	1
21.	E00-2524	BOLT 5/16 X 3-1/2.....	2
22.	E24-5110	UPPER FRAME CLEVIS CASTING.....	1
23.	E00-2416	BOLT 1/4 X 1-3/4.....	1
24.	E24-5100	UPPER ENGINE MOUNT CUP.....	1
25.	E27-5100	CLUTCH ARM CASTING.....	1
26.	E27-3130	CLUTCH ENGAGEMENT HANDLE.....	1
27.	E00-4850	SPACER.....	1
28.	E00-3410	1/4 THIN LOCKNUT.....	4

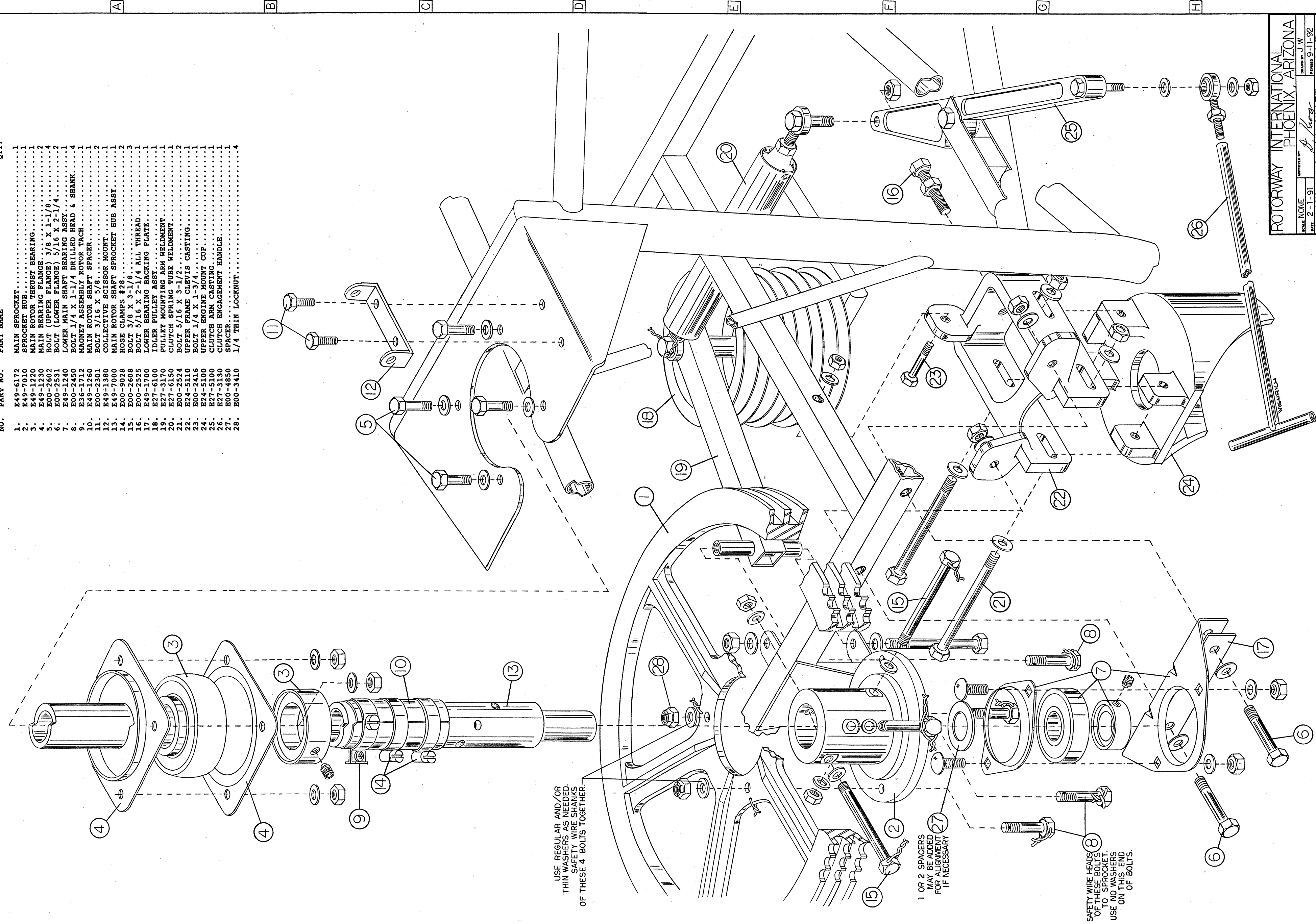

USE REGULAR AND/OR THIN WASHERS AS NEEDED. SAFETY WIRE SHANKS OF THESE 4 BOLTS TOGETHER.

1 OR 2 SPACERS MAY BE ADDED FOR ALIGNMENT IF NECESSARY

SAFETY WIRE HEADS OF THESE BOLTS TO SPROCKET. USE NO WASHERS ON THIS END OF BOLTS.

ROTORWAY INTERNATIONAL
 PHOENIX, ARIZONA
 DRAWN BY: J.W.
 DATE: 2-1-91
 APPROVED BY: [Signature]
 REVISED: 9-11-92
 ELASTOMERIC MAIN SHAFT ENGINE CLUTCH, UPPER ENGINE MOUNT
 PART NUMBER: E49-2001-2

9-11-92 REVISION 2: SAFETY WIRE
 3-6-92 REVISION 1: ADD SPACER